

# SaunaBoat 14

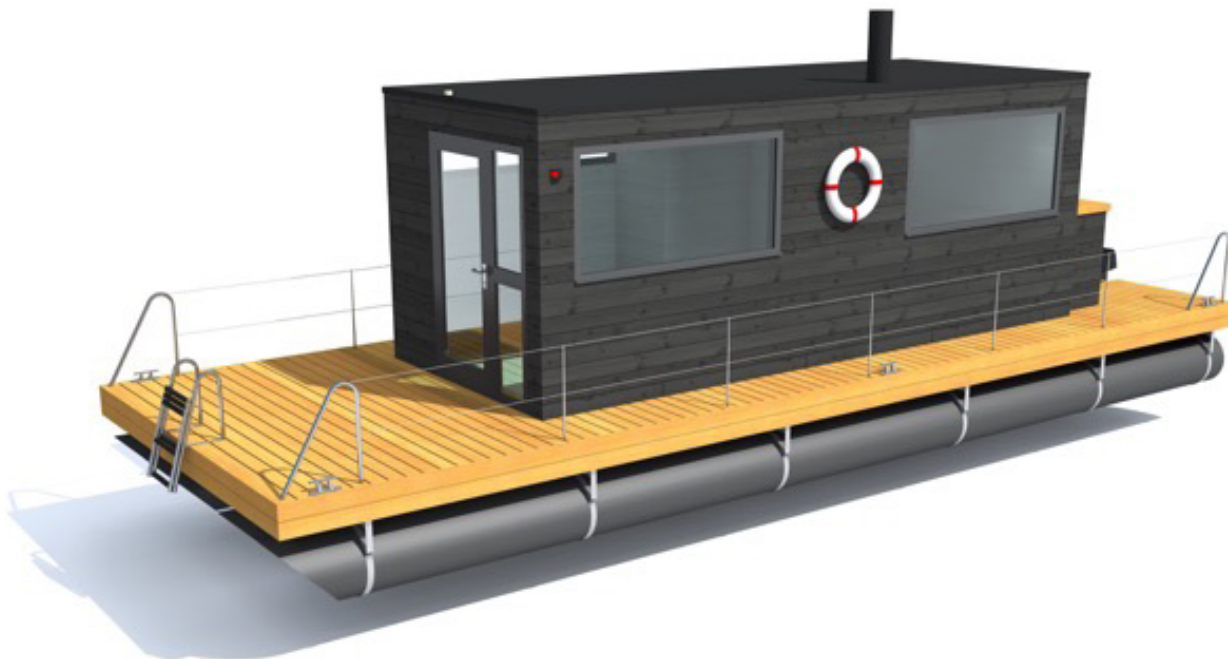

The SaunaBoat is a clever twist on the traditional sauna. The larger model, SaunaBoat 14, is a 10.2m long boat with 14m<sup>2</sup> of indoor space. This is divided into two rooms, i.e. a sauna, dressing room, and a separate toilet cabin. Capable of hosting up to 12 people, it is flexible and sufficiently spacious for occasional overnight accommodation. SaunaBoat 14 boasts a good sized terrace with space for sunbathing and a barbecue. With the boat package, which is available as an extra feature, the SaunaBoat 14 is a CE-certified boat

The cabin is of timber construction and sits on a timber deck. The sauna relies on a traditional wood burning stove. The cabin is mounted on a hot-dipped steel framed platform with plastic tubes.

The SaunaBoat is strong but light in weight, can be transported by road if necessary and is smooth and stable on water. It is easily and safely handled when fitted with an outboard engine of 20hp.

## Layout

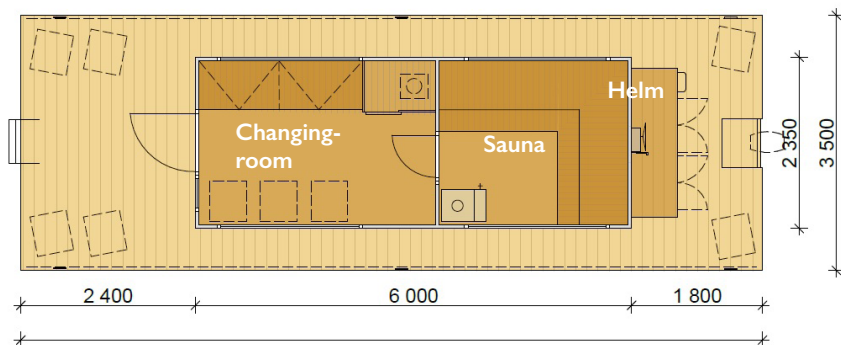

## Technical information

- **Floating base 36 m<sup>2</sup>**  
Hot dipped galvanized steel frame  
Treated pine deck  
Pontoon with plastic tubes T500, 4 pcs
- **Sauna 14,0 m<sup>2</sup>**  
Timber frame (spruce)  
Bitumen felt roof  
Thermal insulated windows  
Glass doors  
A woodburning harvia stove with a water tank  
Room height 2,1 m
- **Features**  
Total weight: 4500 kg  
Total carrying capacity: 2250 kg  
Maximum load: 12 people or 1350 kg  
Engine: 20 hp  
Speed: maximum 5 kn, travel 4 kn
- **Extras (see pricelist)**  
Boat package (CE-certified boat, category-D)  
Accessory package (electric)  
Outboard motor  
Grey water tank  
Solar panel  
Registration equipment

Sales and inquiries

info.finland@marinetek.net | +358 9 682 4100  
marinetek.fi | saunaboat.fi

# PRICE LIST

## Basic model (towed sauna barge, not CE-certified boat)

Floating base 3,5 x 10,2 m

Finished sauna module 14 excluding paint, including:

- Outer walls 45 mm:n timber (spruce)
- Front door, glass (9x20)
- Sauna room door, glass (7x19)
- Windows:: 2 pcs 10x20, 2 pcs 5x20 and 2 pcs 5x10 thermal insulated window element with tempered inner glass
- Sauna seating, aspen, corner model
- Water insulated roof, 22 mm (bitumen felt)
- Harvia ES20PRO stove, rst-flue, protective sheath (black metal), water tank
- Floor without thermal insulation, treated timber in the sauna
- Floor drain in the sauna room
- Molding and roof and window panels
- Mooring cleats, 6 pcs

37 480 €



## Boat package (CE-certified boat)

- Outboard motor rack
- Railings
- Helm (cable steering)
- Standing helm with storage
- CE-plate and CIN-code for the frame
- fire extinguisher 2 kg
- Pivoting swimming ladder, 6 steps, hot dipped galvanized steel

3 530 €

## Accessory package (electric)

- Shore supply (connection plug, 2 sockets, fault current protection)
- 12V power system
- Battery (72 amp) and battery charger
- Electrical panel with fuses (12-volt system)
- Navigation lights (LED)
- LED lighting, 15 pcs in the locker room, strip lighting in the sauna
- Outdoor lighting (LED)

3 430 €

## Extras

Insulated ceiling, aspen panel	2 655 €
52L grey water tank with emptying and suction fitting, inspection hatch	375 €
Outdoor Painting (standard color carbon black)	2 325 €
Outdoor Painting (special color)	2 680 €
Storage chest in the dressing room (depth 0.7 m) and a separate toilet area	1 445 €
Dry Toilet (Caravan Visapot)	115 €
Solar panel connected to a 12-volt power system,	695 €
Radio, bluetooth speakers in the dressing room and sauna area	1 150 €
Socket, 2 pcs. in the changing room	265 €
T-bollard (aluminum, 2.5 tn)	41 €

Pivoting swimming ladder (stainless steel)	640 €
Pivoting swimming ladder (galvanized steel)	295 €
Life Ring (55cm)	49 €
Life Ring (75cm)	72 €
Life ring rack	6 €
Registration equipment (ropes, anchor 10kg, life vests 12 pcs)	495 €
Mercury F20ELPT, remote control device, cables, PA tank (25 l)	4 110 €
Starter battery, battery box, main switch, engine mounting	430 €
Registration number and plate, 2pcs, white	95 €



Sales and inquiries  
[info.finland@marinetek.net](mailto:info.finland@marinetek.net) | +358 9 682 4100  
[marinetek.fi](http://marinetek.fi) | [saunaboat.fi](http://saunaboat.fi)

Prices ex works Vantaa factory, inc.. VAT 24 %.  
 We reserve the right to make changes.  
 © Marinetek Finland Oy